

Artemide®

SOMNĪUM SYSTEM

design
Carlotta de Bevilacqua

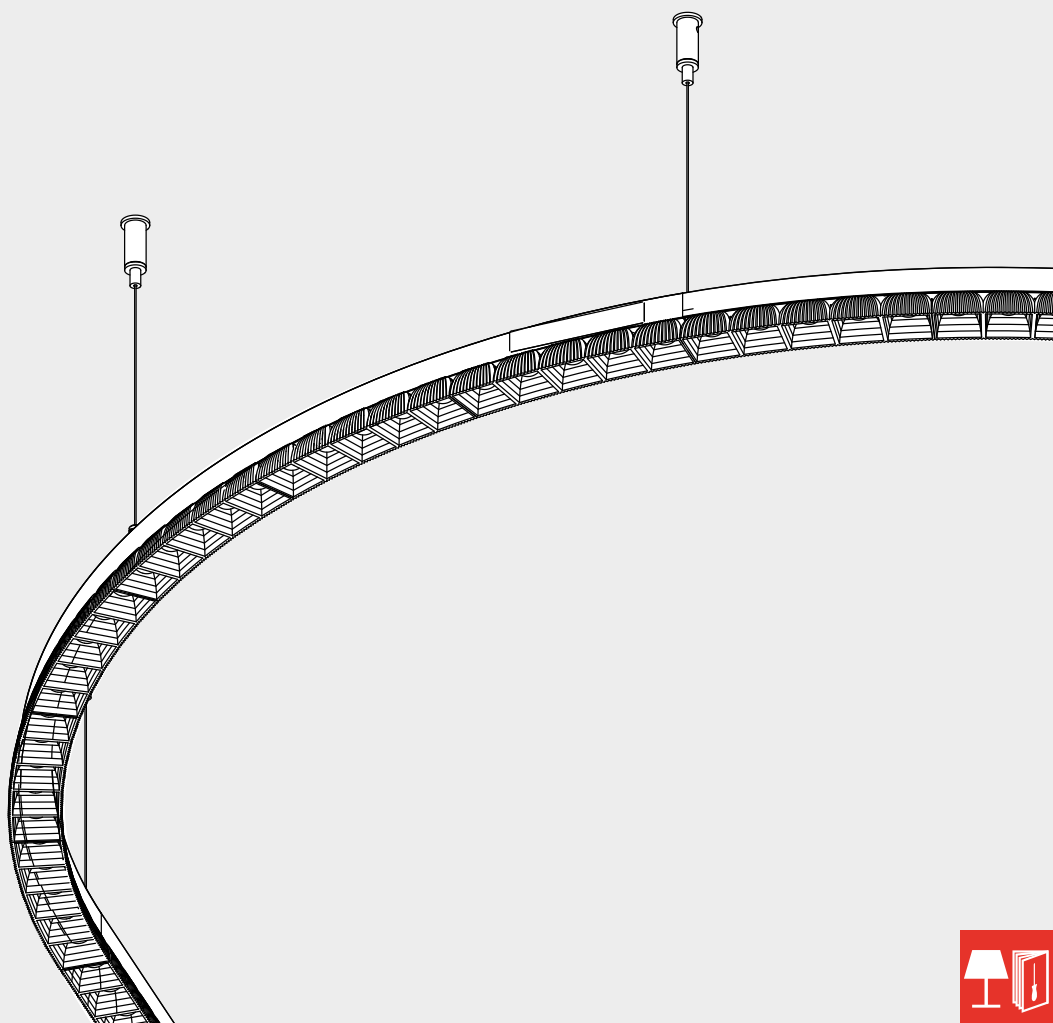



i

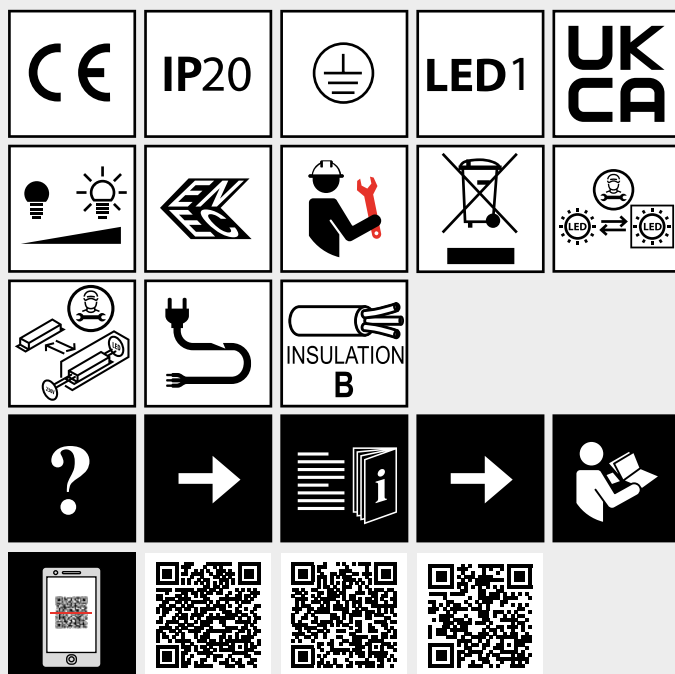

GET IT ON
Google Play

Download on the
App Store

Artemide App
Quick Starting Guide

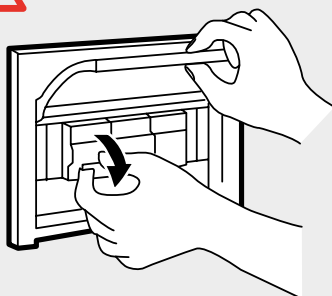
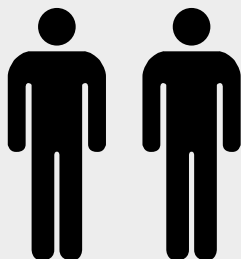

i

A

2100 mm
1260 mm
840 mm
420 mm

C

D

E

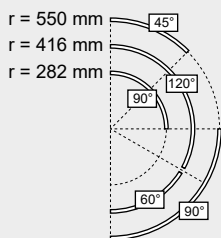

B

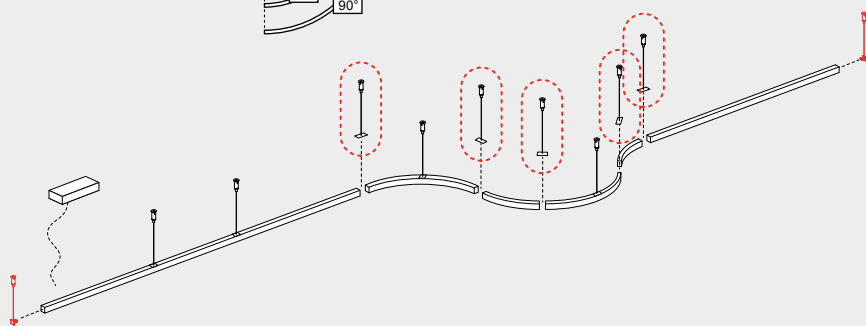

A

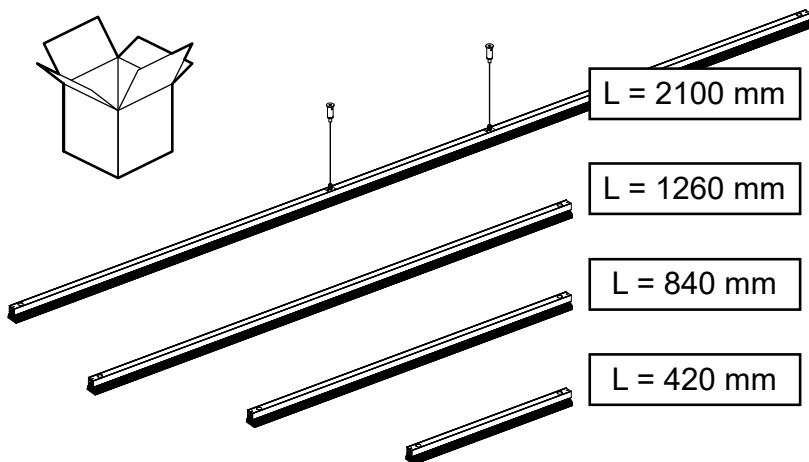
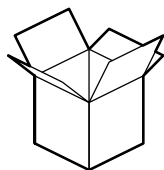
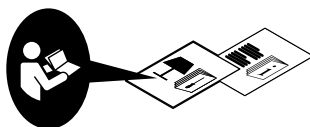

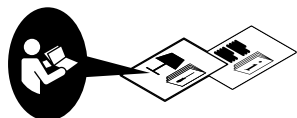
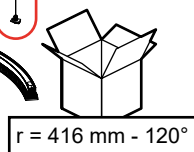
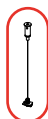
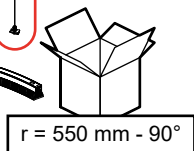
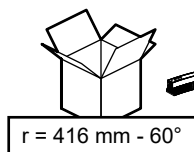
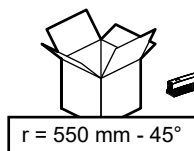
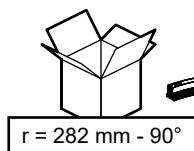
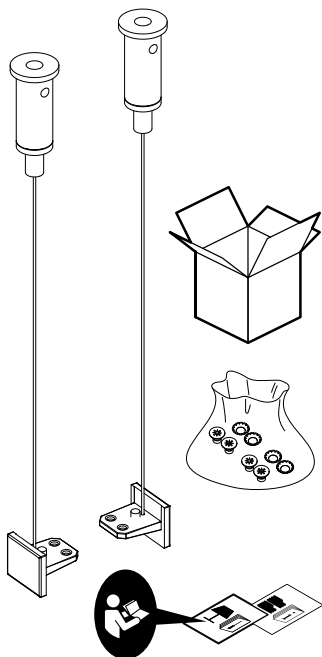
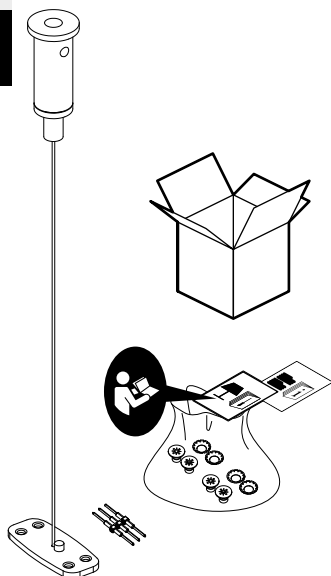
**B****fig. 24****OPTIONAL
USE****C****D**



E

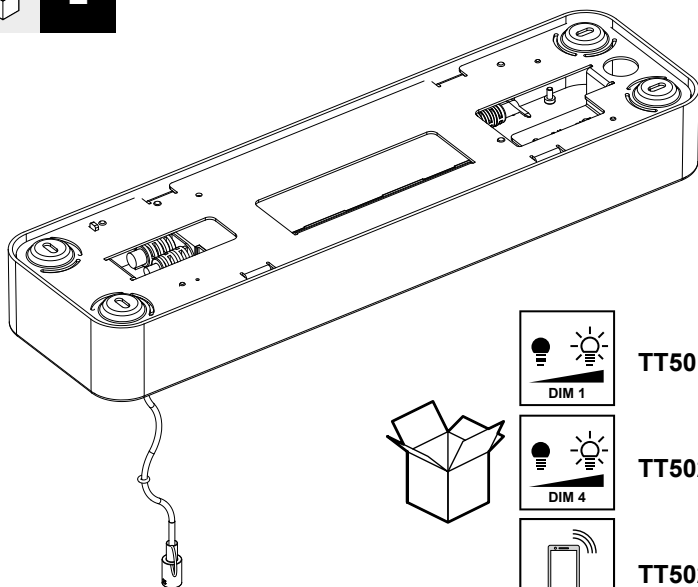

TT50100



TT50200



TT50200APP

i

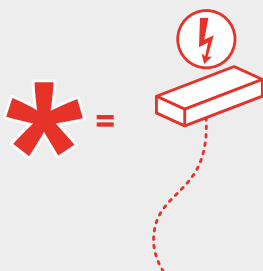
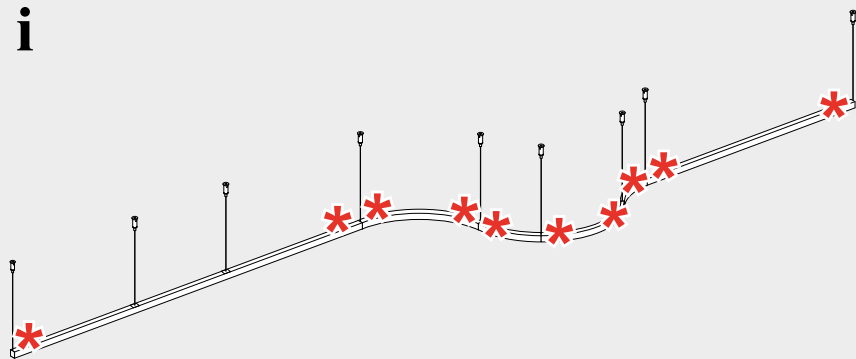

i

Output Max

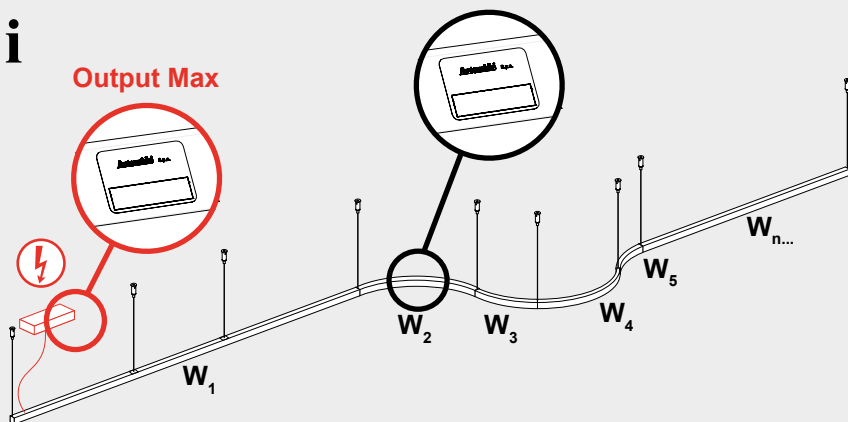

$$W_1 + W_2 + W_3 + W_4 + W_5 + W_6 + \dots + W_N \leq \text{Output Max}$$

i

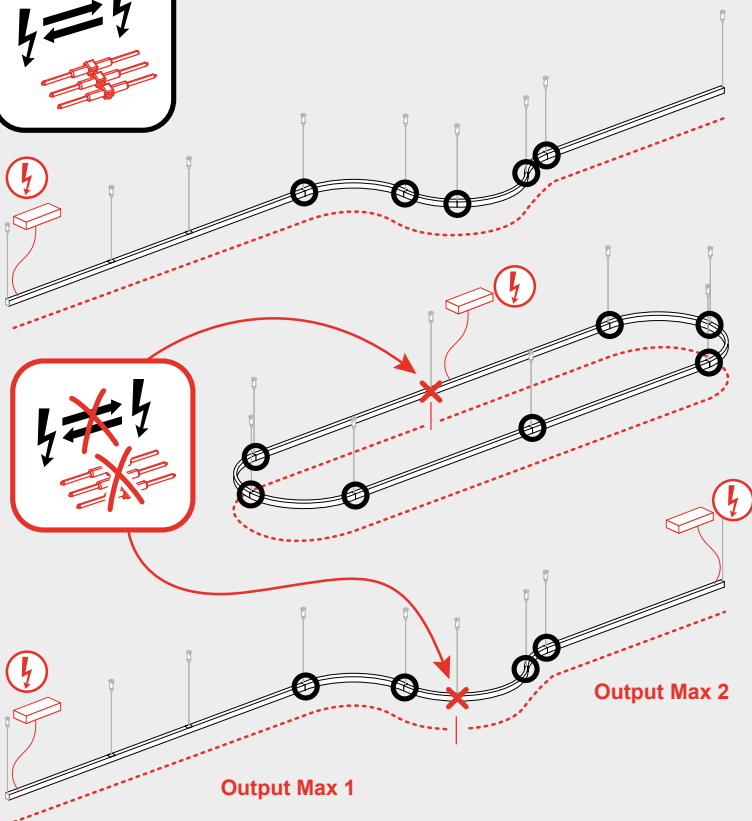
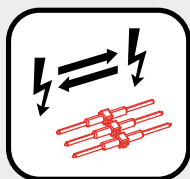

i



Output max = Max admitted power [W]	Inrush current (typ @230VAC) [A]	t_{width} measured at 50% I _{peak} [μsec]	Number of power unit under same MCB		
			B16A	C16A	C20A
175	65	550	3	5	6

i

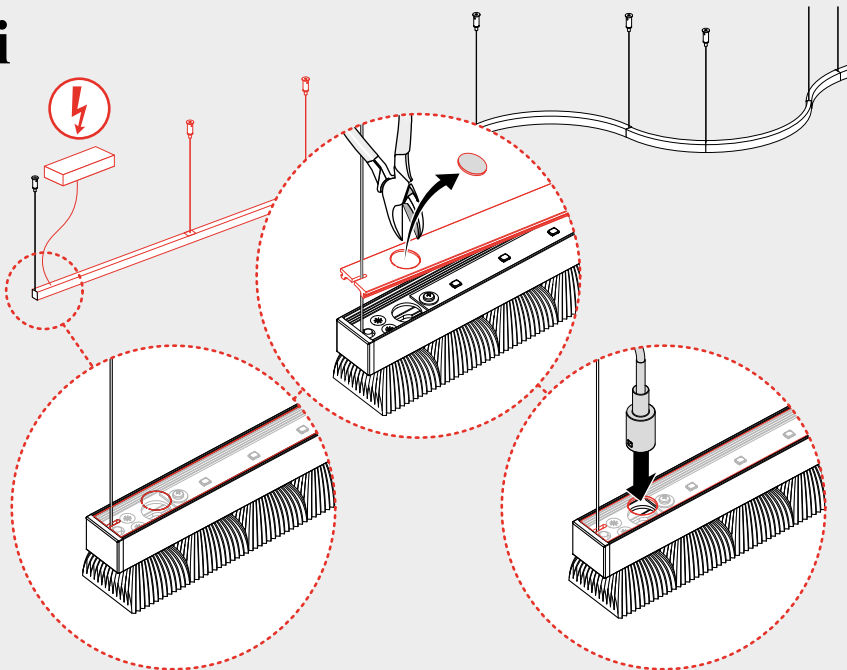

1

Opt.1

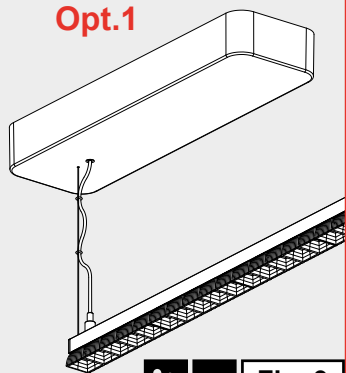

Fig. 9

Opt.2

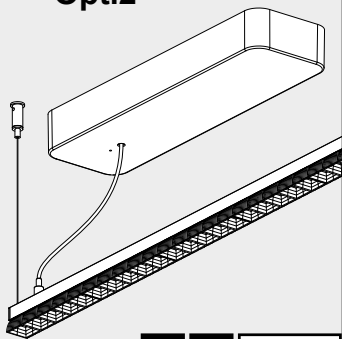
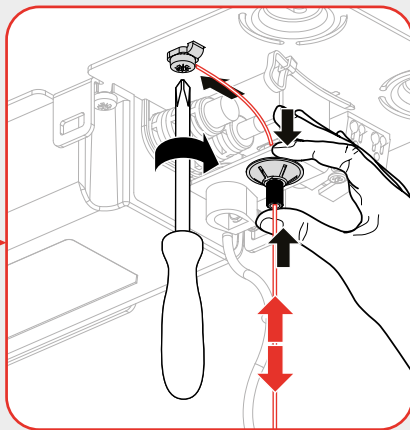
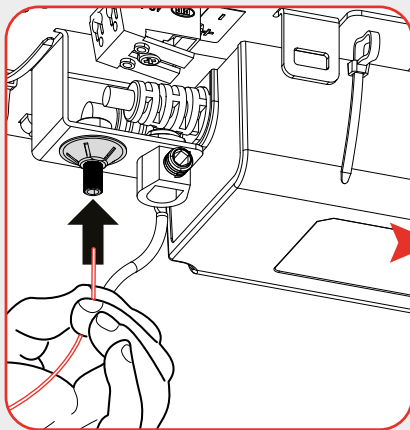
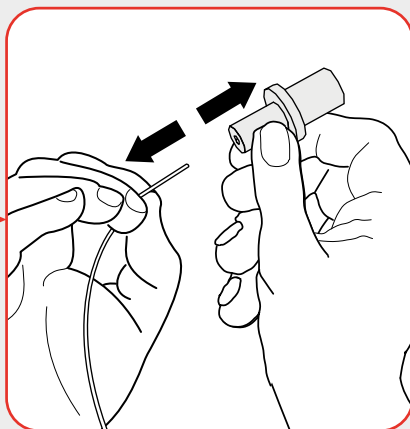
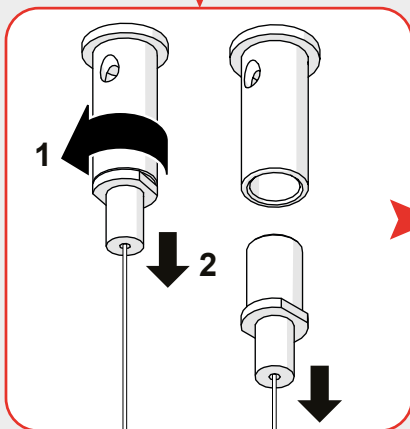
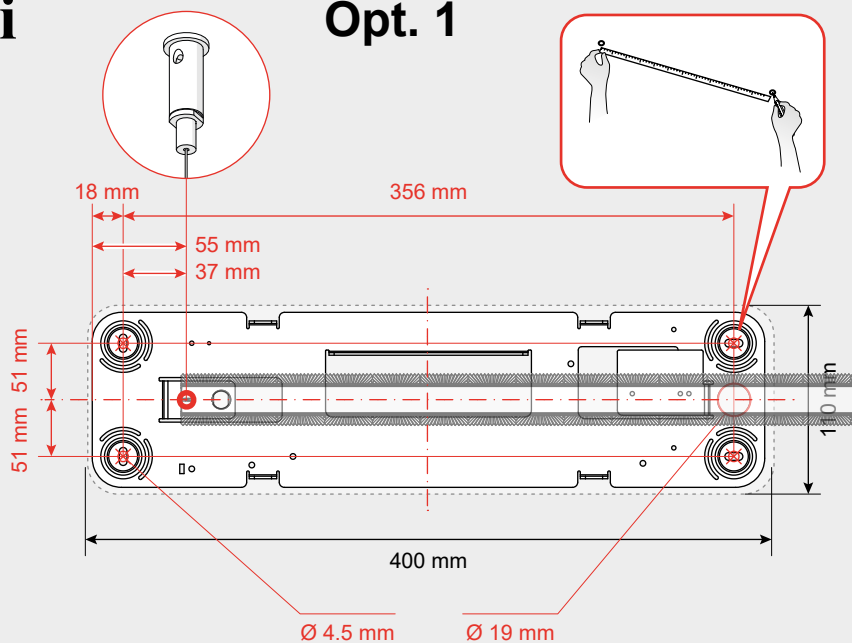
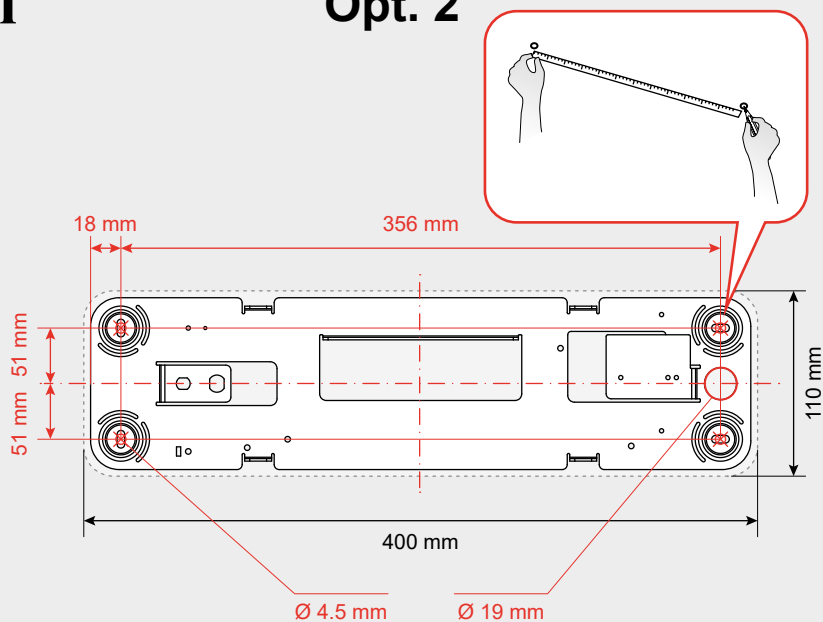
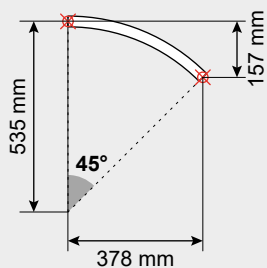
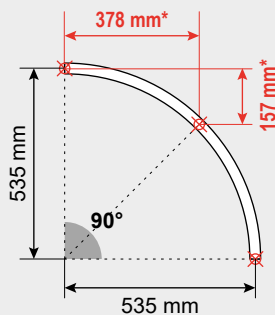
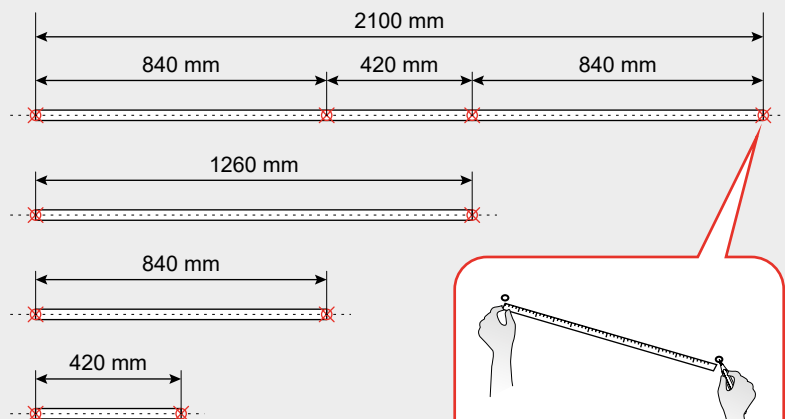

Fig. 4



i**Opt. 1****i****Opt. 2**

i



*OPTIONAL

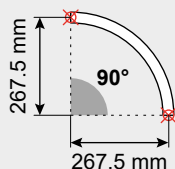
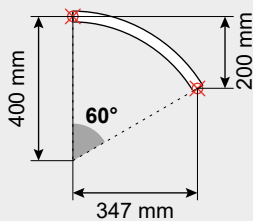
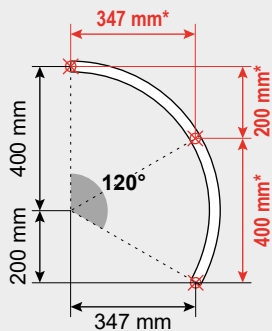

Opt. 1

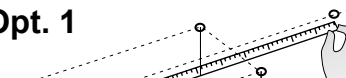

A diagram showing a ruler held at an angle by two hands. Two weights are hanging from the ruler, one near the left hand and one near the right hand. Dashed lines indicate the vertical positions of the weights and the ruler's ends.

3

This diagram shows the third step of the installation. A dashed line indicates the path for the corner brackets. A screwdriver is shown with an arrow indicating it is used to screw the brackets into the wall. An inset box provides a detailed view of the bracket's internal mechanism, showing two vertical slots with arrows indicating the direction of movement. Below the inset, two boxes labeled 'C' and 'D' are shown, each containing a small icon of a box.

4

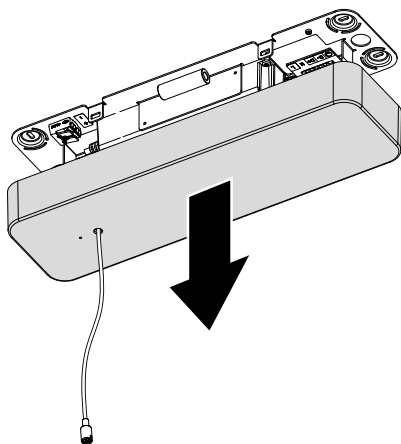

5

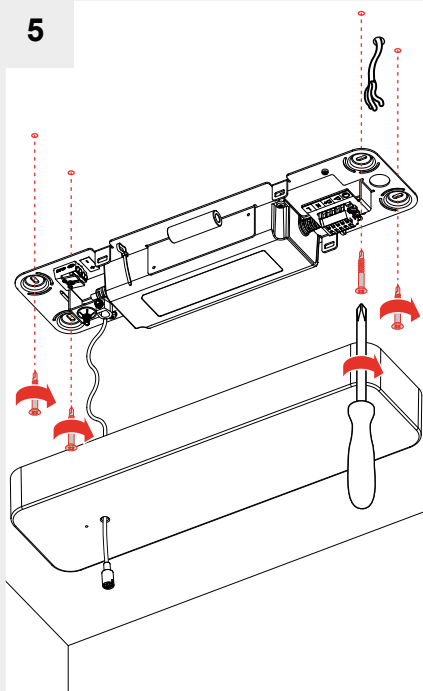

6a

ONLY FOR TT50100

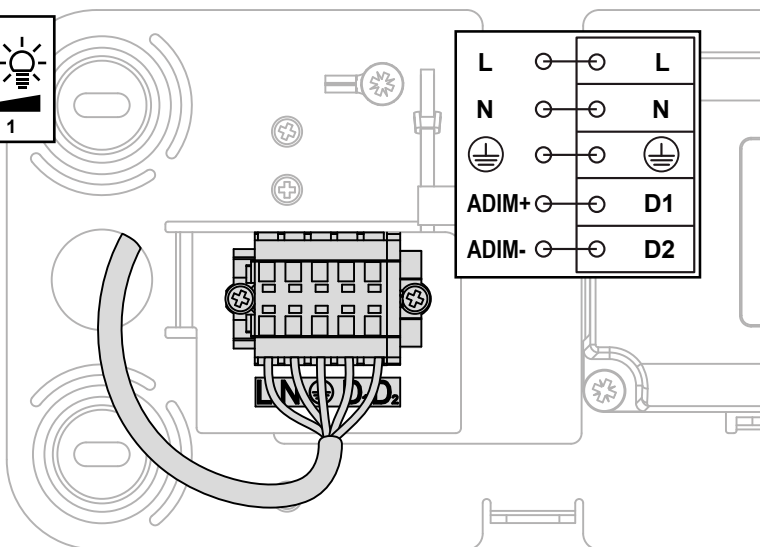
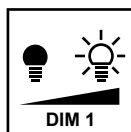

6b **ONLY FOR TT50200**

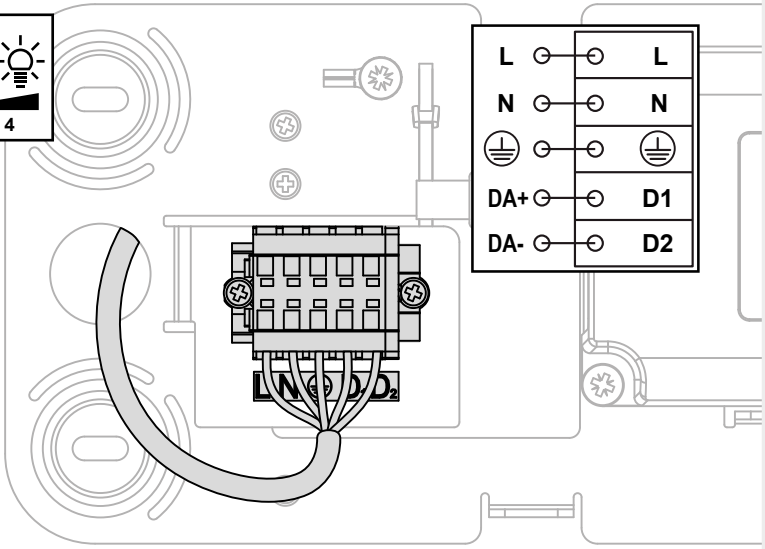
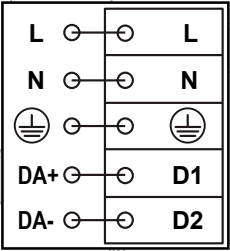
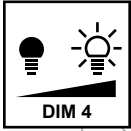

6c **ONLY FOR TT50200**

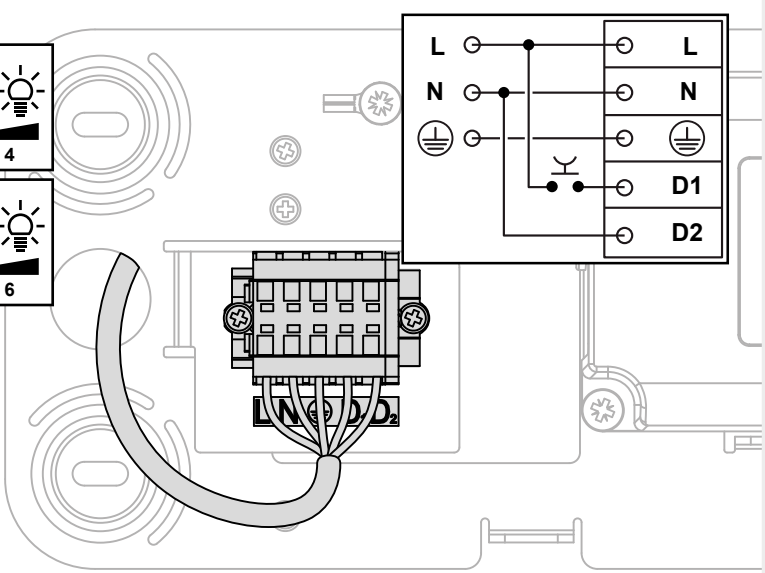
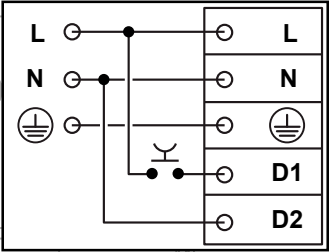
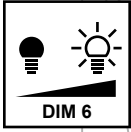
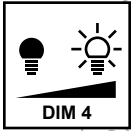

6d

ONLY FOR TT50200APP

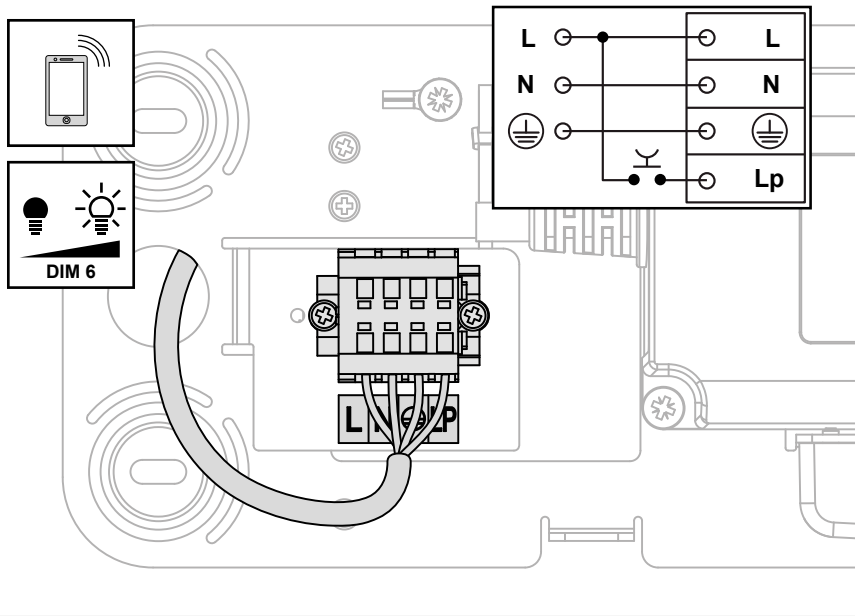

7

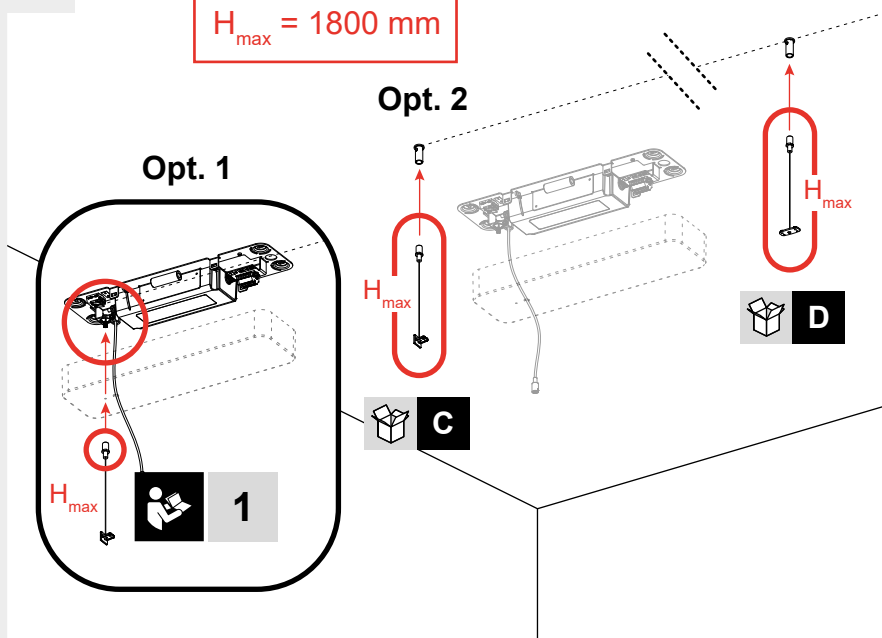
 $H_{\max} = 1800 \text{ mm}$ 

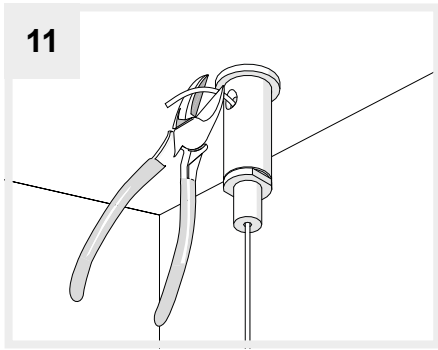
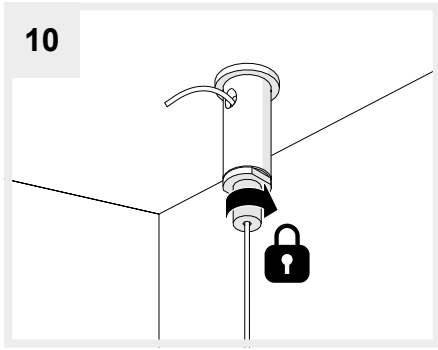
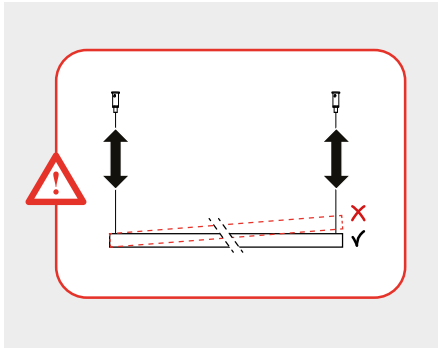
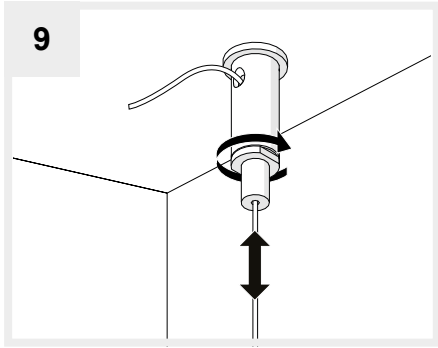
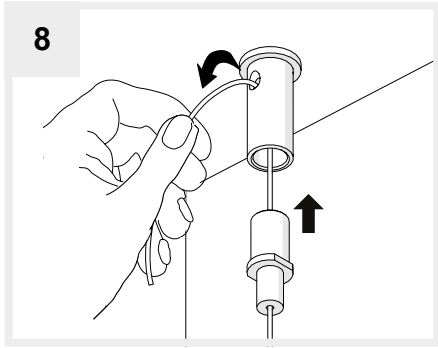

i

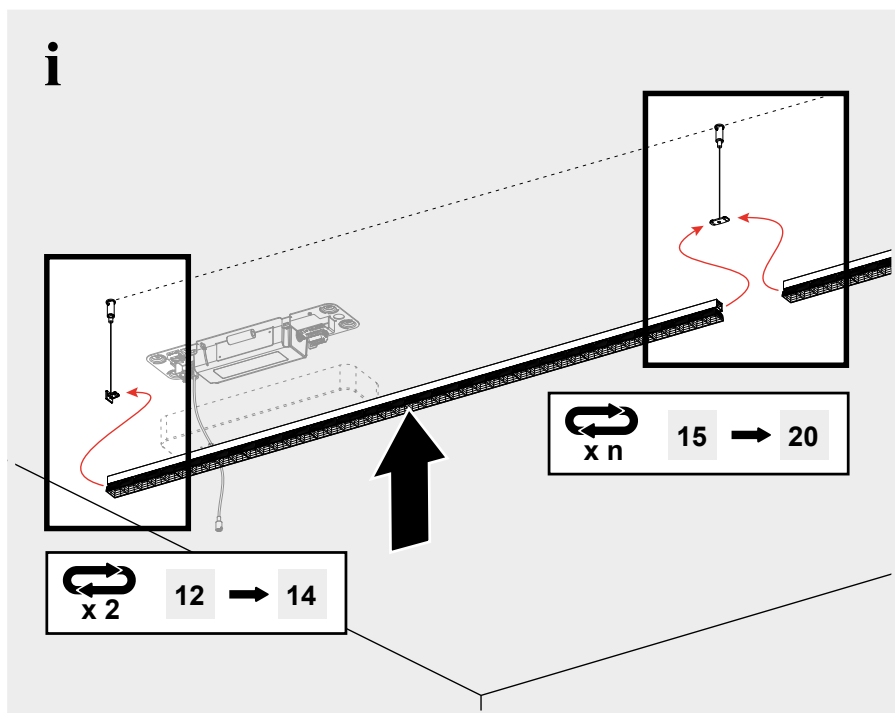

12

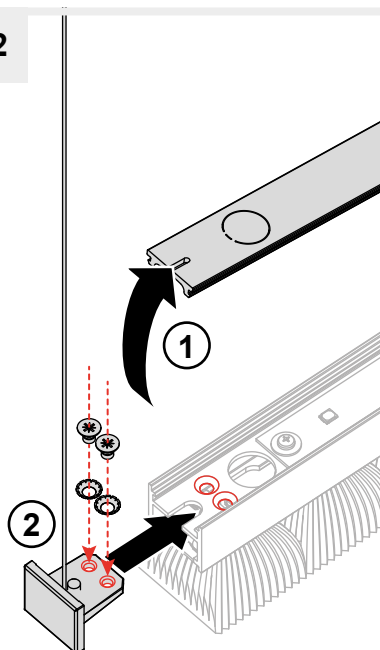

13

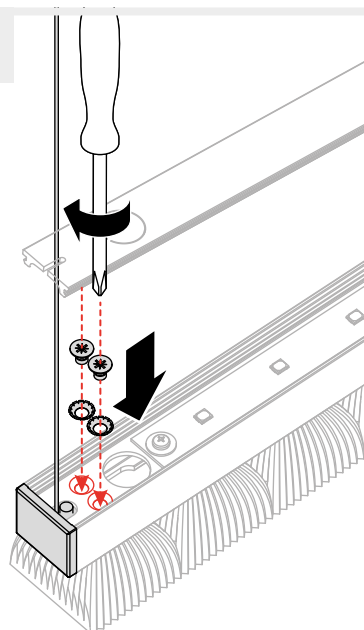

14

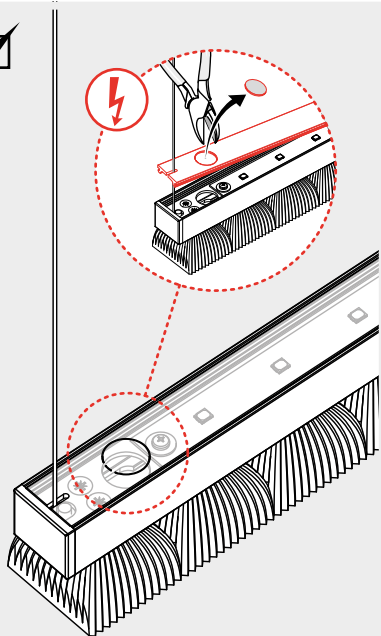
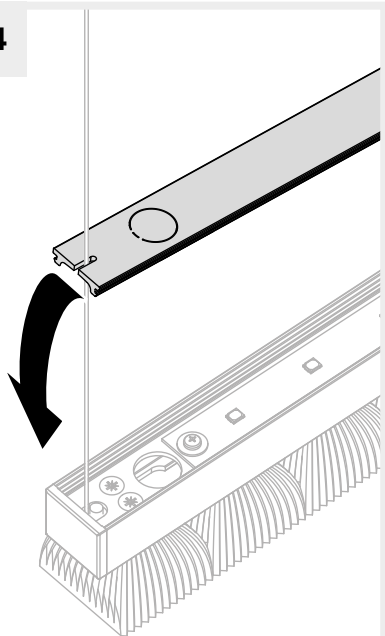

15

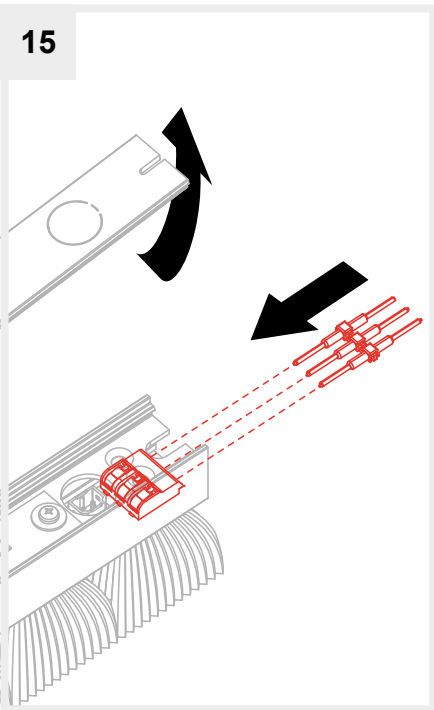

16

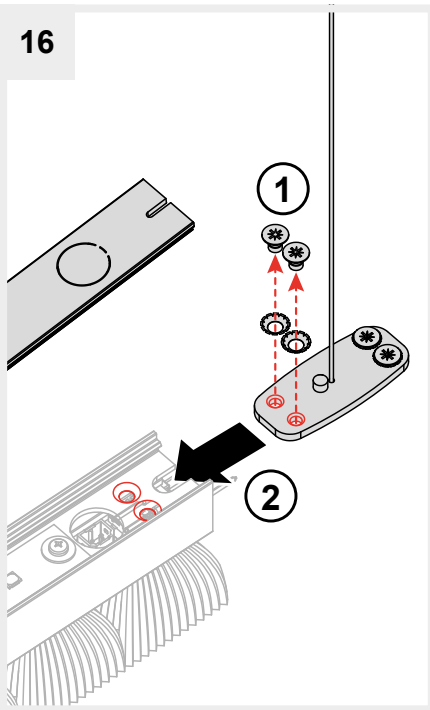

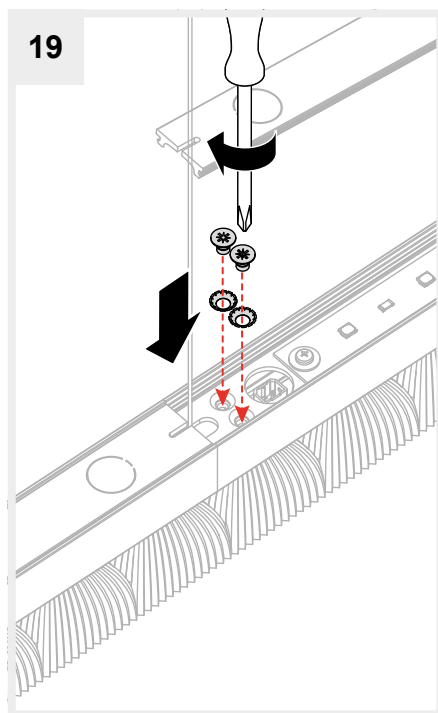
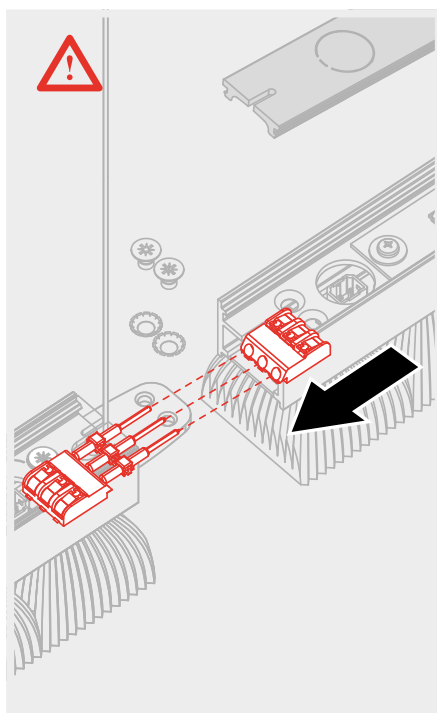
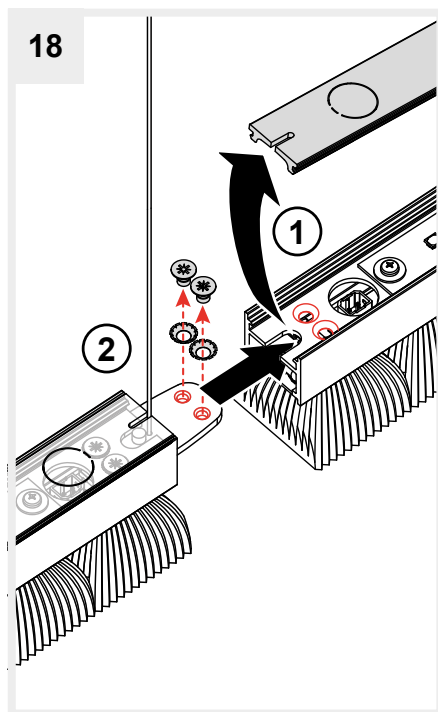
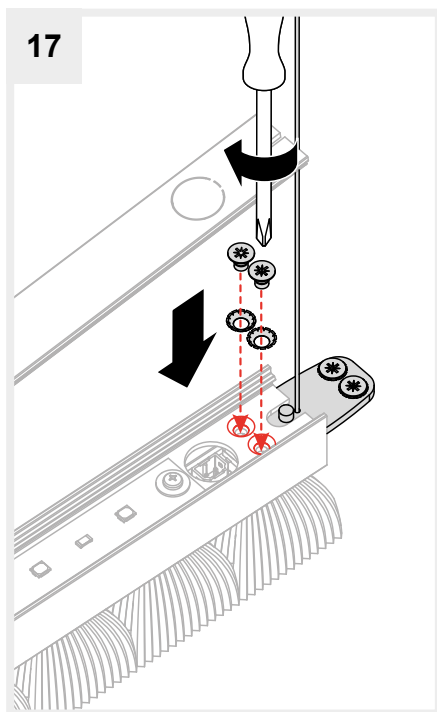

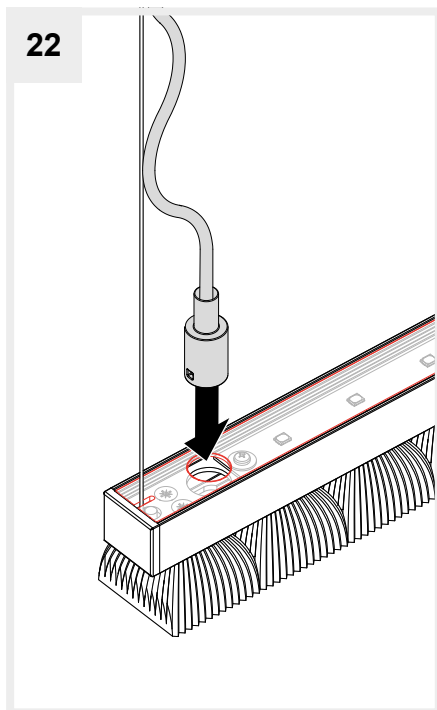
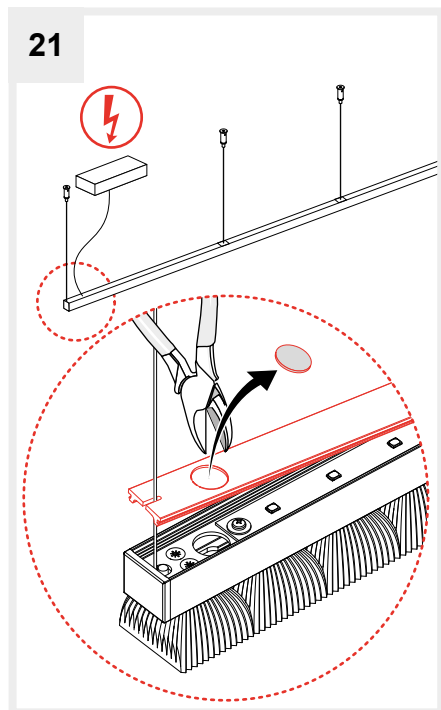
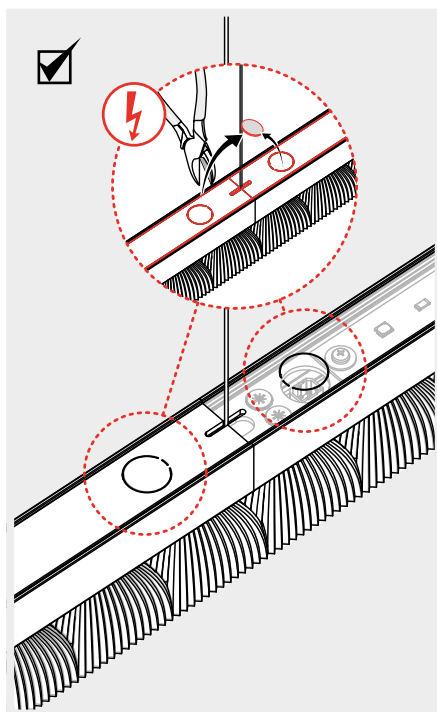
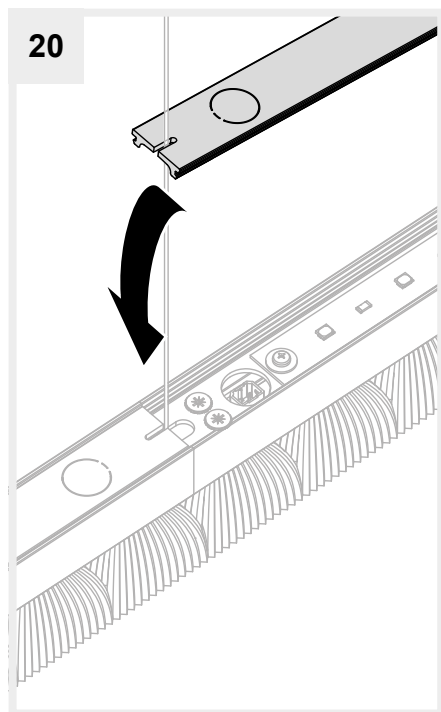

23

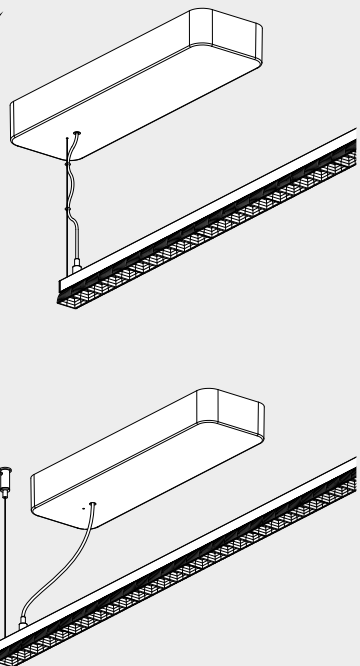
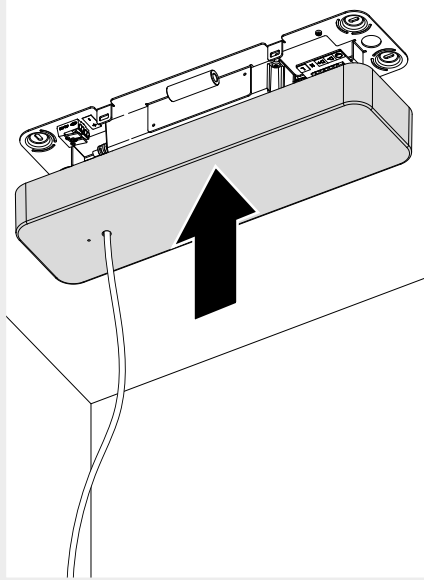

24

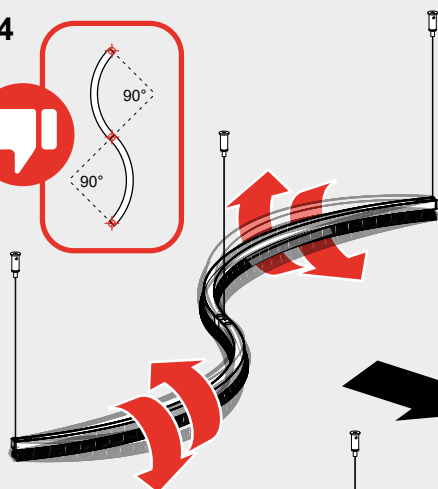
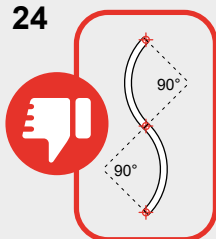
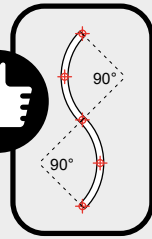
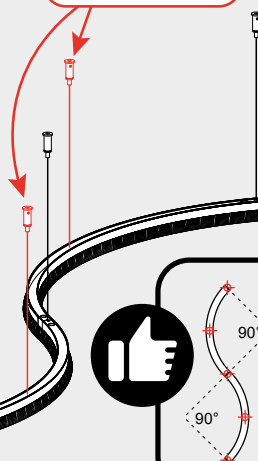
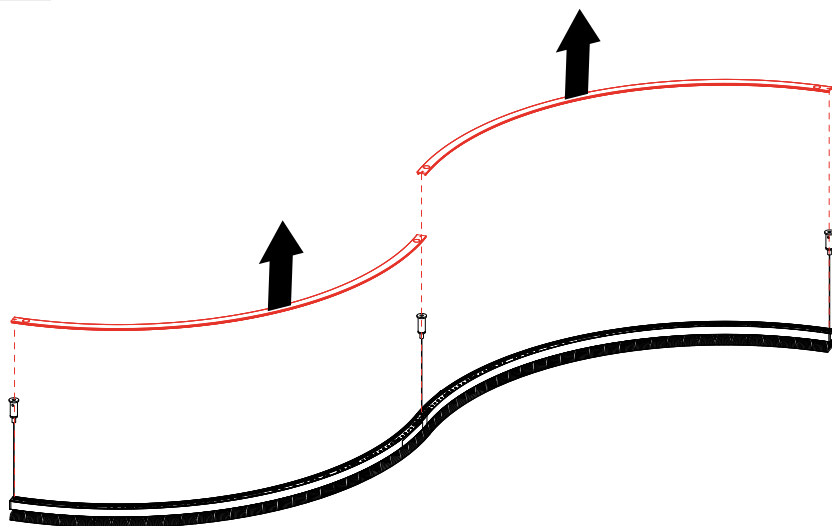

fig. 25 - 34

OPTIONAL
USE



25



26



fig. 2 - 3

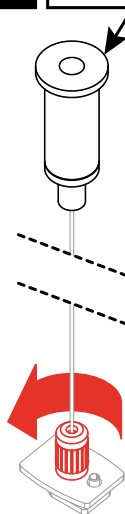

27

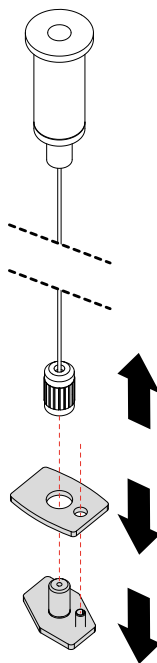

28

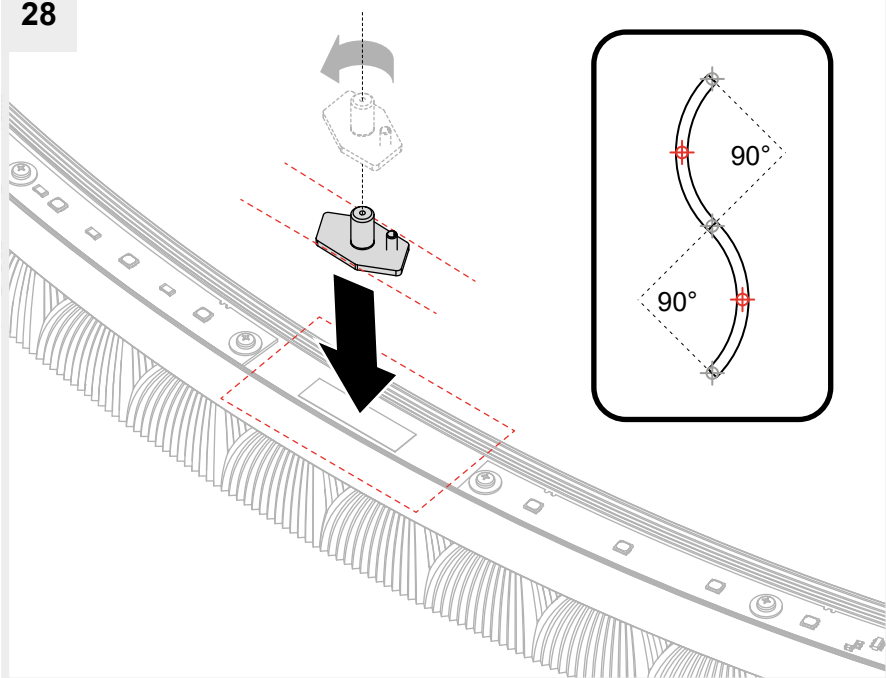

29

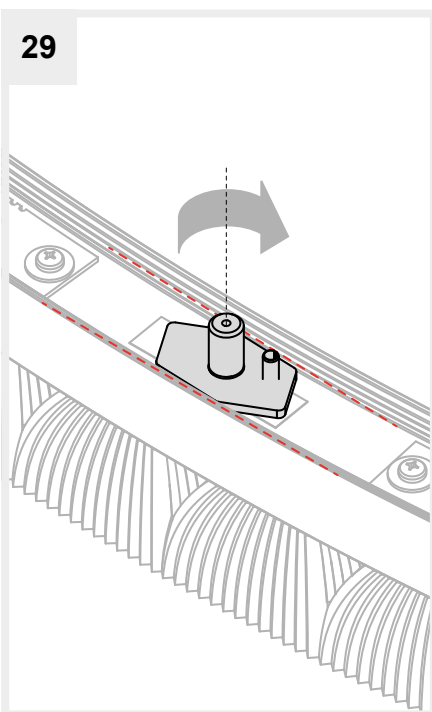

30

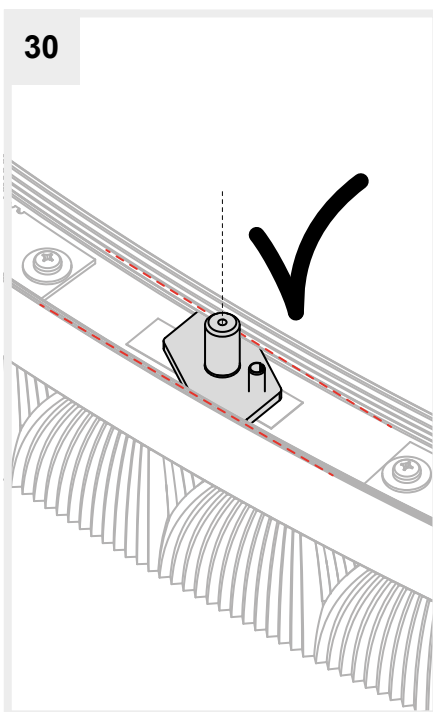

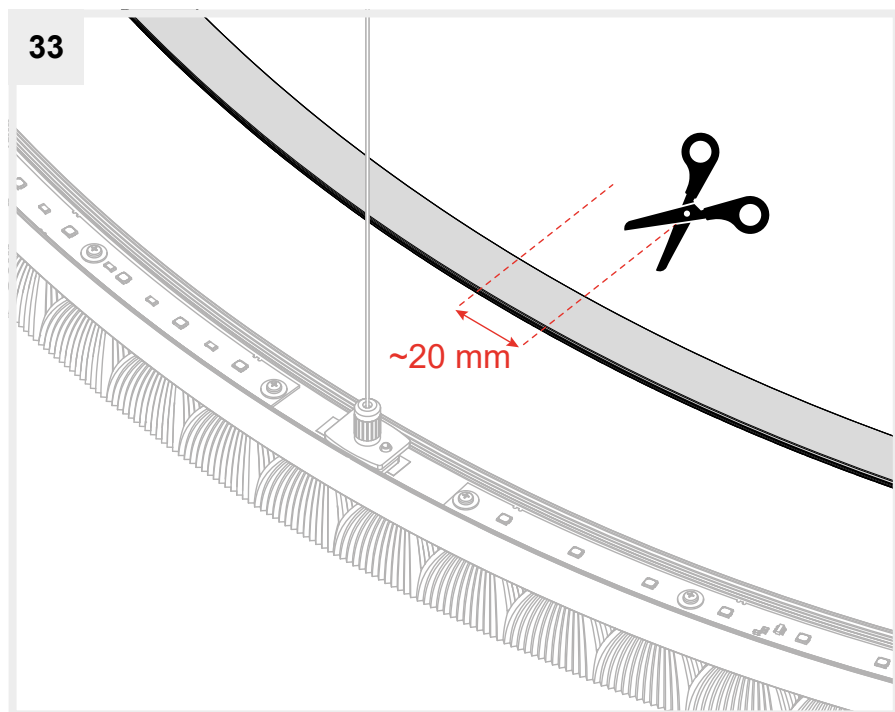
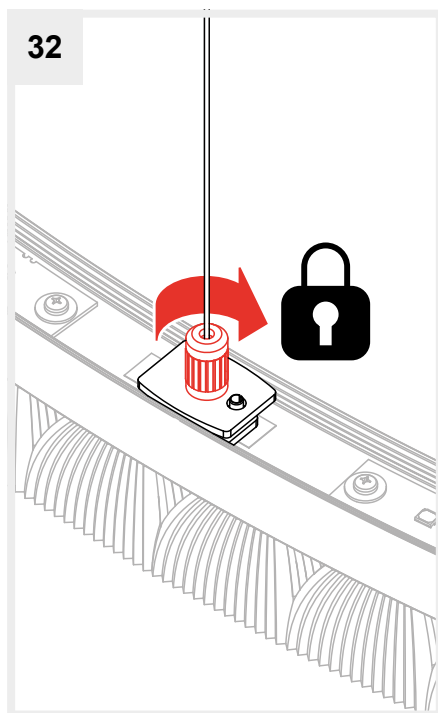
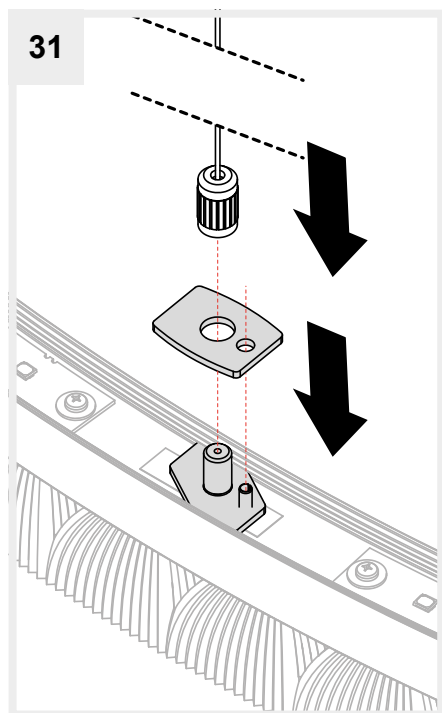

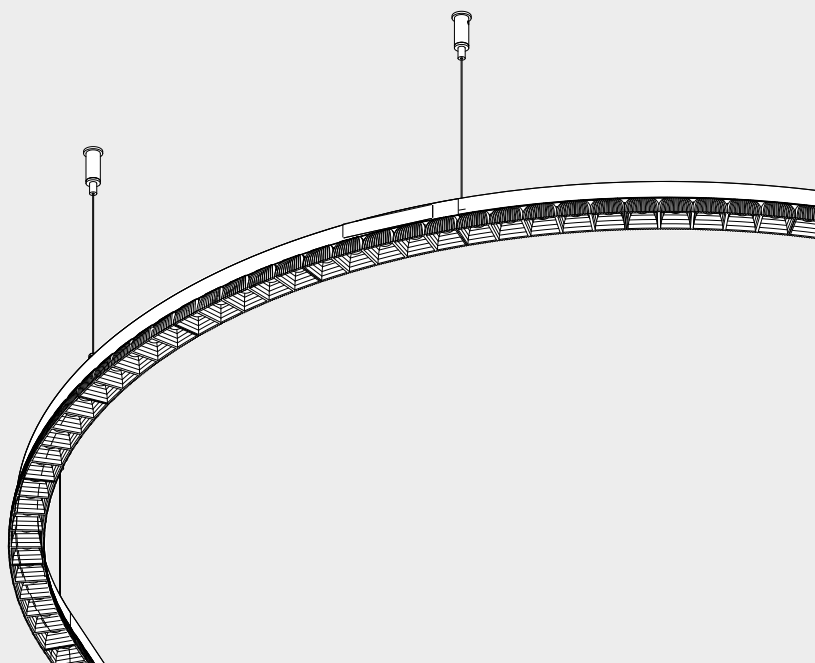
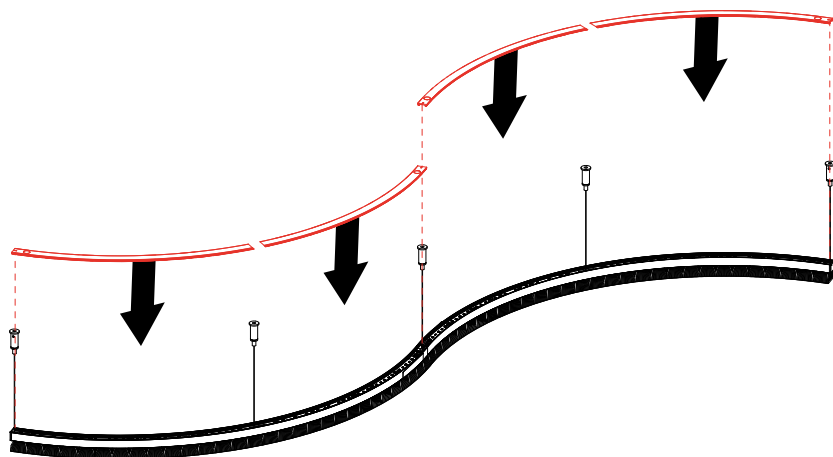

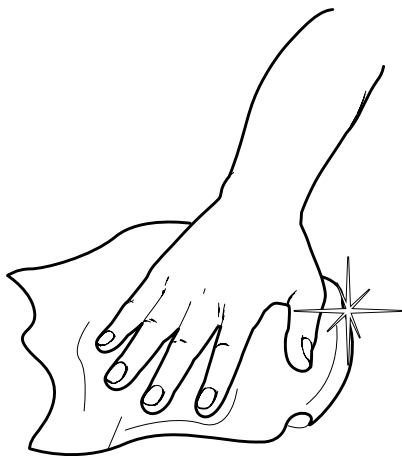
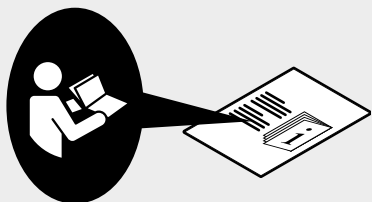

Artemide®

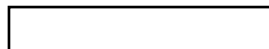

Artemide

via Bergamo, 18
20006 Pregnana M.se (MI)
ITALIA

tel. +39 02 935 181
fax +39 02 935 90 254
fax +39 02 935 90 496

www.artemide.com

VAT IT00846890150

cod. Y513002068A